

**Read all instructions BEFORE assembly and USE of product.
KEEP INSTRUCTIONS FOR FUTURE USE. Prior to using the product, check
that the product and all parts were not damaged during delivery.**

BABY  DELIGHT®

Go With Me™ Span

Expandable Folding Gate

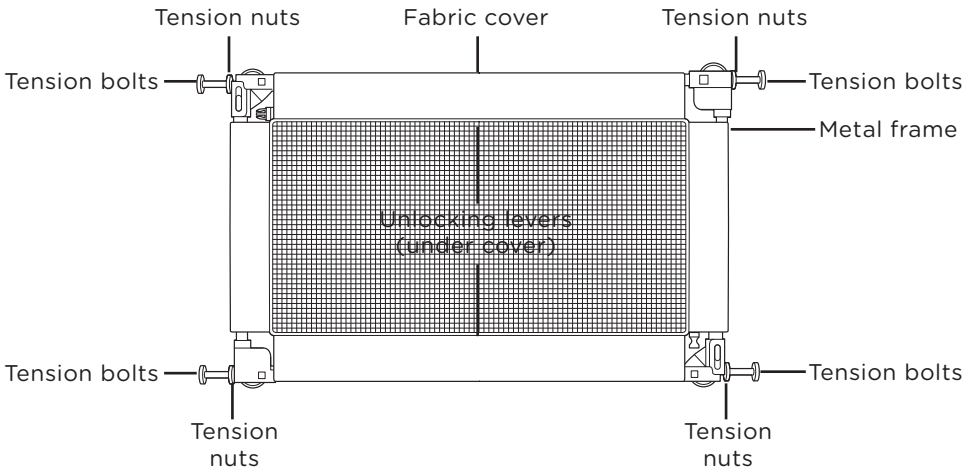

Note: This gate works in openings with a width of 30" - 48"

Care & Instructions

Contents



Gate



Travel Bag

⚠ WARNING: IMPORTANT! KEEP FOR FUTURE REFERENCE!

Children have died or been seriously injured when gates are not securely installed.

- **ALWAYS** install and use gate as directed using all required parts.
- **STOP** using when a child can climb over or dislodge the gate.
- Use **ONLY** with the 4 locking knobs securely tightened. Check frequently and securely tighten as necessary.
- **NEVER** use a gate to keep child away from pool.
- **NEVER** leave child unattended.
- This product will not necessarily prevent all accidents. Proper supervision is required at all times.
- **DO NOT** use if any components are missing or damaged.
- Adult assembly required. Exercise care when unpacking and assembling product.
- Use only on openings between 30" and 48" wide.
- Make sure the bottom of the gate is flat to the floor at each corner.
- **DO NOT** step over gate.
- Make sure the four wall pads fit securely against wall or opening.
- **DO NOT** use on rounded/curved surfaces.
- **DO NOT** use this gate at the top of stairs.

Assembly/Operating

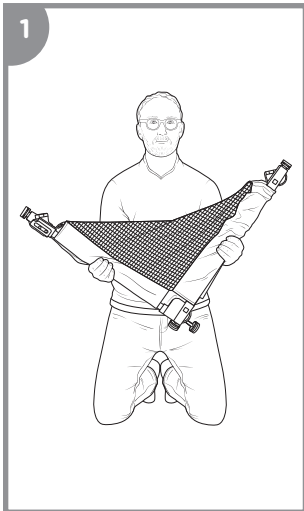

Remove gate from bag, unfasten CLIP and unfold GATE in a V shape.

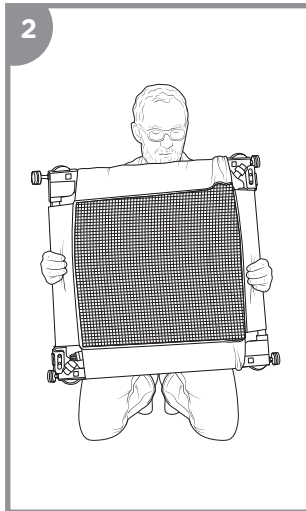

Open GATE to form a square.

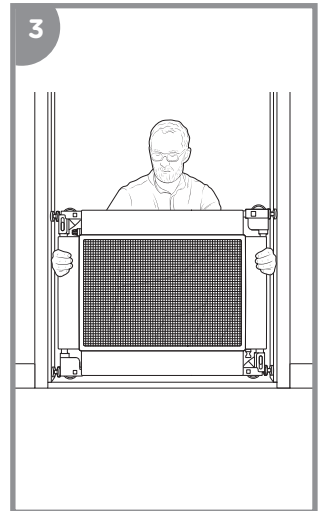

With LOGO on the top rail, expand GATE into doorway opening by pulling apart left and right FRAMES until snug in doorway. Make sure GATE is sitting on the floor.

Assembly/Operating - Continued

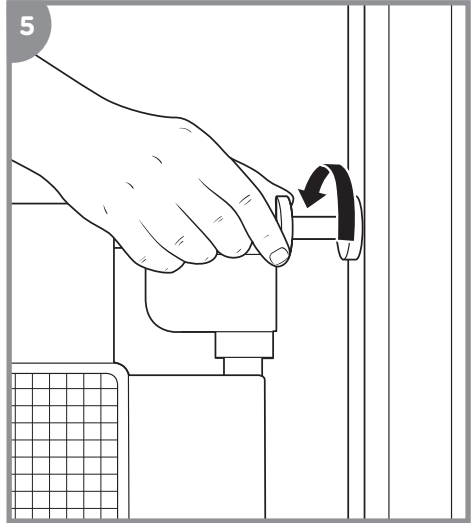
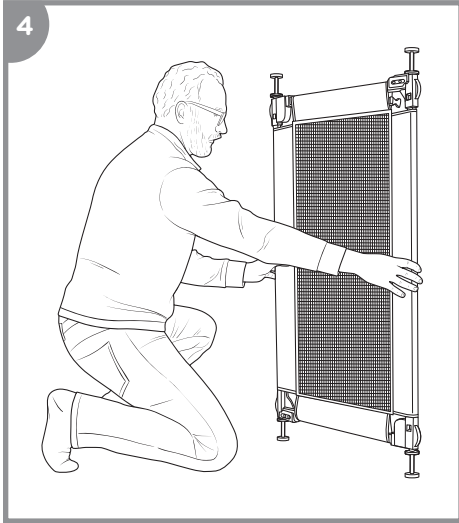

NOTE: If you expand the GATE too widely, simply place GATE on the floor upright with logo facing sideways and press the UNLOCKING LEVERS under the FABRIC COVER at the same time to compress gate to start Step 3 over.

Rotate top TENSION NUT on right and left side counter-clockwise until tight in the door opening.

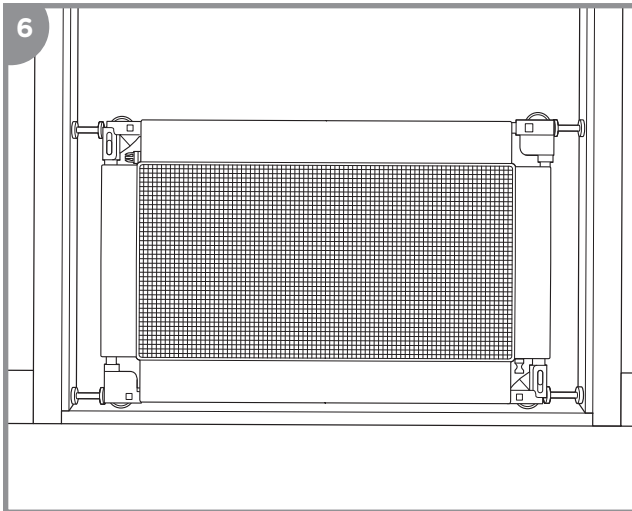

Repeat for bottom TENSIONING NUTS until entire GATE is tight in the doorway.

Note: For walls without molding, top and bottom gaps on each side between GATE and doorway should be equal.

Removing from doorway and folding for travel

Rotate TENSION NUTS clockwise at each corner until GATE is loose enough to remove from doorway

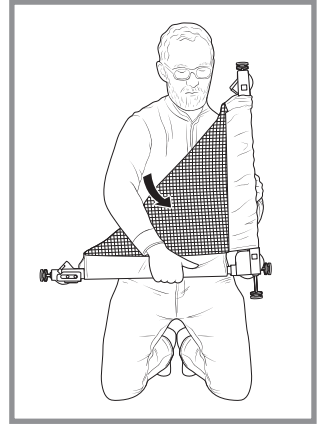
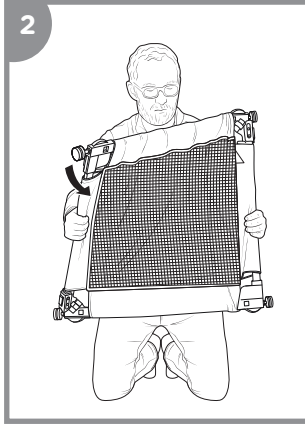
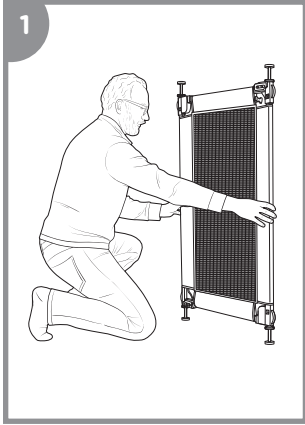

Turn gate on its side with logo on the righthand side and press UNLOCKING LEVERS under the FABRIC COVER on both sides at the same time to compress gate. Gate should compress to a square shape.

With CORNER HINGES facing you, fold opposite corners (without HINGES) toward each other until GATE folds into a "V" shape.
NOTE: If GATE does not fold easily, re-expand gate and then compress again making sure gate is fully compressed (about 26" x 26") per Step 1.

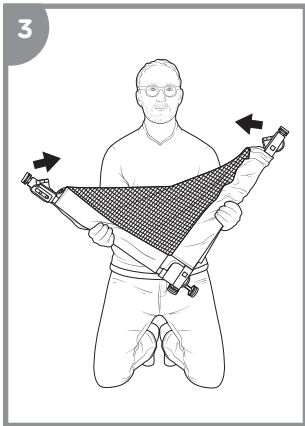

When in "V" Shape, fold until the corners come together.

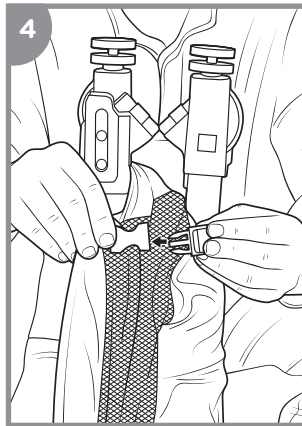

Snap clip together and place in bag for storage.

Care & Cleaning

Caring for your new GoWithMe™ Span Expandable Folding Gate is very easy.

- Regularly check TENSION BOLTS to make sure the GATE is securely in place.
- Do not use the GATE if any components are damaged or missing.
- Surface-clean with a damp cloth or sponge, using mild detergent and warm water.

Limited Warranty

At Baby Delight, Inc. we make innovative and high quality products for babies, children and their parents. We warrant this product to be free from defects in material and workmanship existing at the time of manufacture for a period of 90-days from the date of initial purchase (sales receipt is required for proof of purchase). If such a defect is discovered during the limited warranty period, we will, at our sole option, repair or replace your product at no cost to you.

This limited warranty does not cover claims resulting from misuse, failure to follow the instructions on installation, maintenance and use, abuse, alteration, involvement in an accident, and normal wear and tear.

For warranty service or replacement part information:

USA: Please call 1-401-333-6800, email info@babydelight.com, or write to Consumer Services: 30 Martin Street, Suite 3C, Cumberland, RI 02864

Some replacement parts may be available for purchase after this limited warranty expires. Please visit us at www.babydelight.com or call us at 1-401-333-6800 or details.



www.babydelight.com

© 2019 Baby Delight, Inc. | 30 Martin Street, Suite 3C, Cumberland, RI, 02864, USA

1-401-333-6800 | info@babydelight.com

Patent Pending | BD05410